

These New 60PP Series couplings bring the highest available 3/8" flow with both valved and non-valved configurations. They are manufactured from medical grade, gamma sterilizable polypropylene. The cost efficient high flow couplings offer a larger, more robust thumb-latch and greater chemical resistance. The New and Improved Panel Mount couplings offer a stronger, more reliable design for thicker wall panels and other various applications. All 60PP couplings interconnect with all other 60 Series couplings as well as other similar industry thumb-latch type high flow couplings.

**Performance Ratings:**

- Operating Pressure: Vacuum to 60 psi; (4.2bar)
- Temperature: 32°F to 160°F (0°C to 71°C)
- Flow Capacity: 3/8" Size

**Materials & Construction:**

- Bodies & Terminations: Medical Grade Polypropylene
- Internal Valves: Medical Grade Polypropylene
- Internal Valve Springs: 316 Stainless Steel
- External Springs & Pins: Stainless Steel
- O-rings: Peroxide-cured EPDM (others available)
- Thumb-latch: Medical Grade Polypropylene

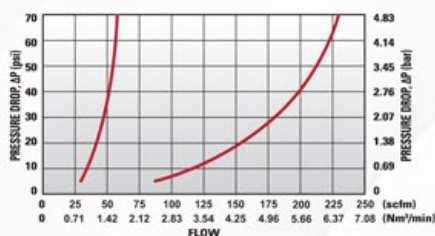
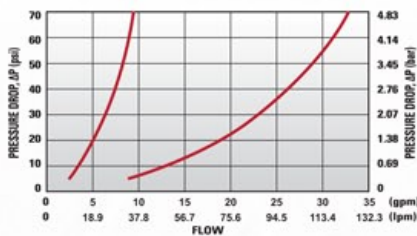
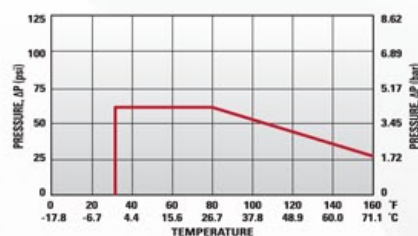
**60PP Series Air Flow**

**60PP Series Water Flow**

**60PP Series Temperature**

**FLOW RATES**

The data below shows liquid flow rates for LinkTech couplings. Each coupling combination was tested at 70°F (21°C).

**C<sub>v</sub> Values for 60PS Series Couplings**

SOCKETS	60PP-PE2-06	60PPV-PE2-06	60PP-PE2-08	60PPV-PE2-06	60PP-PE4-06	60PPV-PE4-06	60PP-PE4-08	60PPV-PE4-08	60PP-PE1-06	60PPV-PE1-06	60PP-PE1-08	60PPV-PE1-08	60PP-PE2-12	60PPV-PE2-12
60PPV-SE1-06	1.27	1.27	1.62	1.51	1.14	1.14	1.46	1.36	1.80	1.58	1.70	1.65	-	-
60PPV-SE1-08	1.28	1.34	1.62	1.51	1.15	1.24	1.46	1.36	1.81	1.54	1.72	1.56	-	-
60PPV-SE3-06	1.07	1.00	1.17	1.14	0.96	0.90	1.05	1.03	1.33	1.26	1.30	1.24	-	-
60PPV-SE3-08	1.25	1.23	1.61	1.52	1.13	1.11	1.45	1.37	1.79	1.60	1.68	1.56	-	-
60PPV-SE2-06	1.07	1.00	1.17	1.14	0.96	0.90	1.05	1.03	1.33	1.26	1.30	1.24	-	-
60PPV-SE2-08	1.25	1.23	1.61	1.52	1.13	1.11	1.45	1.37	1.79	1.60	1.68	1.56	-	-
60PP-S2-12	-	-	-	-	-	-	-	-	-	-	-	-	3.94	-
60PPV-SE2-12	-	-	-	-	-	-	-	-	-	-	-	-	-	2.04

Specific coupling combination flow rates can be determined by using this formula:

$$Q = C_v \sqrt{\frac{\Delta P}{S}}$$

- Q = Flow rate in gallons per minute
- C<sub>v</sub> = Average flow rates (see chart)
- ΔP = Pressure drop across coupling (psi)
- S = Specific gravity of liquid.

	PANEL OPENING	MAX PANEL THICKNESS	MIN PANEL THICKNESS
SOCKETS	See Drawing	0.3"	0.03"
PLUGS	1.21"	0.3"	0.03"

**PANEL NUT HEX SIZE**

1.375"

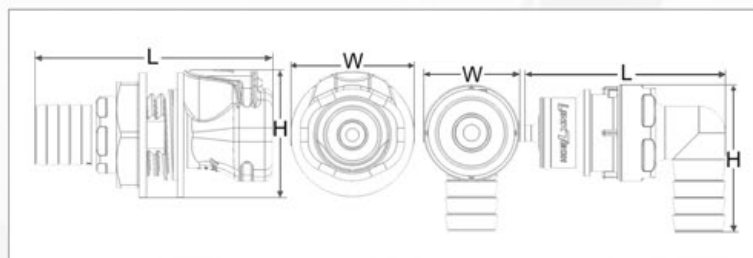
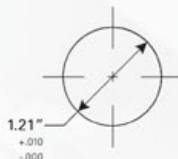

Reference Dimensions: L = Length, W = Width, H = Height

# 60PP Series Sockets

Tubing Size 3/8"-3/4"  
3/8" Flow Polypropylene



## MALE THREAD SOCKET

Non-Valved	Valved	Thread Size	Length	Width	Height
60PP-S1-06	60PPV-SE1-06	3/8" NPT	2.78"	1.36"	1.44"
60PP-S1-08	60PPV-SE1-08	1/2" NPT	2.93"	1.36"	1.44"
60PP-S1-12	60PPV-SE1-12	3/4" NPT	3.13	1.36"	1.44"



## IN-LINE HOSE BARB SOCKET

Non-Valved	Valved	Tube Size	Metric Tube	Length	Width	Height
60PP-S2-06	60PPV-SE2-06	3/8" ID	9.5mm ID	2.78"	1.36"	1.44"
60PP-S2-08	60PPV-SE2-08	1/2" ID	12.7mm ID	2.88"	1.36"	1.44"
60PP-S2-12	60PPV-SE2-12	3/4" ID	19.0mm ID	2.93"	1.36"	1.44"



## PANEL MOUNT HOSE BARB SOCKET (GASKET SEAL INCLUDED)

Non-Valved	Valved	Tube Size	Metric Tube	Length	Width	Height
60PP-S3-06	60PPV-SE3-06	3/8" ID	9.5mm ID	2.86"	1.62"	1.65"
60PP-S3-08	60PPV-SE3-08	1/2" ID	12.7mm ID	3.03"	1.62"	1.65"
60PP-S3-12	60PPV-SE3-12	3/4" ID	19.0mm ID	3.08"	1.62"	1.65"



## PANEL MOUNT HOSE BARB ELBOW SOCKET (GASKET SEAL INCLUDED)

Non-Valved	Valved	Tube Size	Metric Tube	Length	Width	Height
60PP-S22-06	60PPV-SE22-06	3/8" ID	9.5mm ID	2.96"	1.62"	1.73"
60PP-S22-08	60PPV-SE22-08	1/2" ID	12.7mm ID	2.96"	1.62"	1.83"



## PANEL MOUNT SEALING GASKET

Part No.	Material	Diameter	Thickness
C11416	EPDM	1.62" OD	0.06"

Tube Size 3/8"-3/4"  
3/8" Flow Polypropylene

# 60PP Series Plugs



MALE THREAD PLUG						
Non-Valved	Valved	Thread Size	L(nv/v)	Width	Height	
60PP-PE1-06	60PPV-PE1-06	3/8" NPT	1.87"/2.01"	1.14"	1.00"	
60PP-PE1-08	60PPV-PE1-08	1/2" NPT	2.02"/2.16"	1.14"	1.00"	
60PP-PE1-12	60PPV-PE1-12	3/4" NPT	2.22"/2.36"	1.21"	1.05"	



IN-LINE HOSE BARB PLUG						
Non-Valved	Valved	Tube Size	Metric Tube	L(nv/v)	Width	Height
60PP-PE2-06	60PPV-PE2-06	3/8" ID	9.5mm ID	1.87"/2.01"	1.00"	1.00"
60PP-PE2-08	60PPV-PE2-08	1/2" ID	12.7mm ID	1.97"/2.11"	1.00"	1.00"
60PP-PE2-12	60PPV-PE2-12	3/4" ID	19.0mm ID	2.02"/2.16"	1.00"	1.00"



PANEL MOUNT HOSE BARB PLUG (GASKET SEAL INCLUDED)						
Non-Valved	Valved	Tube Size	Metric Tube	L(nv/v)	Width	Height
60PP-PE3-06	60PPV-PE3-06	3/8" ID	9.5mm ID	2.74"/2.88"	1.62"	1.62"
60PP-PE3-08	60PPV-PE3-08	1/2" ID	12.7mm ID	2.84"/2.98"	1.62"	1.62"
60PP-PE3-12	60PPV-PE3-12	3/4" ID	19.0mm ID	2.89"/3.03"	1.62"	1.62"



PANEL MOUNT HOSE BARB ELBOW PLUG (GASKET SEAL INCLUDED)						
Non-Valved	Valved	Tube Size	Metric Tube	L(nv/v)	Width	Height
60PP-PE22-06	60PPV-PE22-06	3/8" ID	9.5mm ID	2.86"/3.00"	1.62"	1.73"
60PP-PE22-08	60PPV-PE22-08	1/2" ID	12.7mm ID	2.86"/3.00"	1.62"	1.83"



ELBOW HOSE BARB PLUG						
Non-Valved	Valved	Tube Size	Metric Tube	L(nv/v)	Width	Height
60PP-PE4-06	60PPV-PE4-06	3/8" ID	9.5mm ID	1.94"/2.08"	1.00"	1.40"
60PP-PE4-08	60PPV-PE4-08	1/2" ID	12.7mm ID	1.94"/2.08"	1.00"	1.50"