

50AC Series Couplings

Tubing Size 1/4" - 3/8"
1/4" Flow Acetal (POM)



These 1/4" flow size couplings are produced in a durable natural Acetal (POM) thermoplastic. They feature a more cost efficient plastic thumb-latch design. They are available in both valved and non-valved configurations. All 50AC couplings interconnect with all other 50PP and 50GP couplings as well as other similar industry thumb-latch type couplings.

Performance Ratings:

- Operating Pressure: Vacuum to 120psi; (8.3bar)
- Temperature: -40°F to 180°F; (-40°C to 82°C)
- Flow Capacity: 1/4" Size

Materials & Construction:

- Bodies & Terminations: Acetal (POM)
- Internal Valves: Acetal (POM)
- Internal Valve Springs: 316 Stainless Steel
- O-rings: FDA & NSF Grade Buna-N (others available)
- Thumb-latch: Acetal (POM)

50AC Series Air Flow

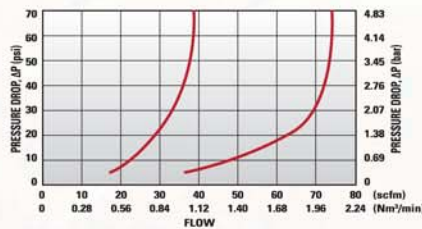

50AC Series Water Flow

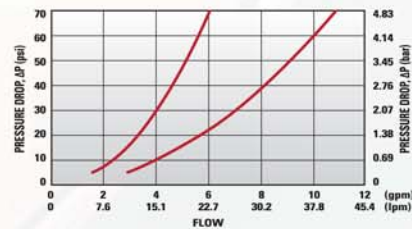

FLOW RATES

The data below shows liquid flow rates for LinkTech couplings. Each coupling combination was tested at 70°F (21°C).

C_v Values for 50AC Series Couplings

SOCKETS	50ACV-PB2-04	50AC-PB2-04	50ACV-PB2-06	50AC-PB2-06	50ACV-PB9-04	50AC-PB9-04	50ACV-PB9-06	50AC-PB9-06	50ACV-PB1-04	50AC-PB1-04	50ACV-PB1-06	50AC-PB1-06
50ACV-SB2-04	0.42	0.58	0.45	0.78	0.31	0.38	0.45	0.6	0.43	0.79	0.45	0.75
50AC-S2-04	0.52	0.95	0.7	1	0.38	0.39	0.55	0.87	0.65	0.95	0.65	1
50ACV-SB2-06	0.43	0.63	0.5	0.89	0.33	0.39	0.62	0.5	0.45	0.95	0.5	0.92
50AC-S2-06	0.53	0.95	0.8	1.4	0.38	0.39	0.57	1	0.7	1.4	0.73	1.4
50ACV-SB3-04	0.42	0.58	0.45	0.78	0.31	0.38	0.45	0.6	0.43	0.79	0.45	0.75
50AC-S3-04	0.52	0.95	0.7	1	0.38	0.39	0.55	0.87	0.65	0.95	0.65	1
50ACV-SB3-06	0.43	0.63	0.5	0.89	0.33	0.39	0.62	0.5	0.45	0.95	0.5	0.92
50AC-S3-06	0.53	0.95	0.8	1.4	0.38	0.39	0.57	1	0.7	1.4	0.73	1.4
50ACV-SB1-04	0.41	0.65	0.5	0.81	0.31	0.35	0.48	0.74	0.45	0.8	0.45	0.8
50AC-S1-04	0.56	0.84	0.83	1.4	0.35	0.4	0.58	1.04	0.75	1.4	0.78	1.4
50ACV-SB1-06	0.43	0.7	0.5	1.03	0.3	0.36	0.7	0.48	0.45	0.97	0.48	1
50AC-S1-06	0.57	0.84	0.82	1.4	0.35	0.4	0.6	1.05	0.75	1.4	0.75	1.4

Specific coupling combination flow rates can be determined by using this formula:

$$Q = C_v \sqrt{\frac{\Delta P}{S}}$$

Q = Flow rate in gallons per minute
 C_v = Average flow rates (see chart)
 ΔP = Pressure drop across coupling (psi)
 S = Specific gravity of liquid.

	PANEL OPENING	MAX PANEL THICKNESS	MIN PANEL THICKNESS
SOCKETS	See Drawing	0.5"	0.05"
PLUGS	0.688"	0.3"	0.05"

PANEL NUT HEX SIZE	PANEL NUT THREAD
13/16"	11/16" - 24 UNS

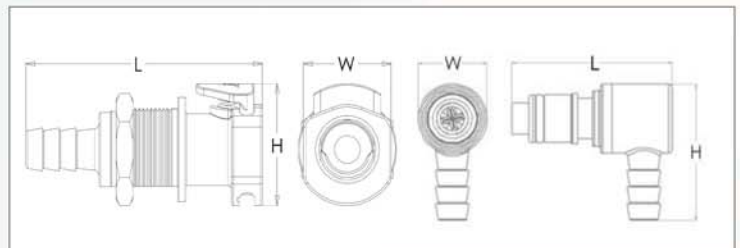
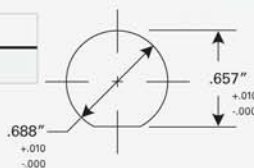

Reference Dimensions: L = Length, W = Width, H = Height

Tubing Size 1/4" - 3/8"
1/4" Flow Acetal (POM)

50AC Series Sockets



MALE THREAD SOCKET						
Non-Valved	Valved	Thread Size	Length	Width	Height	
50AC-S1-04	50ACV-SB1-04	1/4" NPT	1.40"	.75"	.94"	
50AC-S1-06	50ACV-SB1-06	3/8" NPT	1.40"	.75"	.94"	



MALE THREAD SOCKET, WITH LATCH GUARD						
Non-Valved	Valved	Thread Size	Length	Width	Height	
50AC-S35107	50ACV-S35107	1/4" NPT	1.40"	.75"	.94"	



IN-LINE HOSE BARB SOCKET, SHORT BODY						
Non-Valved	Tube Size	Metric Tube	Length	Width	Height	
50AC-S2-04	1/4" ID	6.4mm ID	1.35"	.75"	.94"	
50AC-S2-06	3/8" ID	9.5mm ID	1.35"	.75"	.94"	



IN-LINE HOSE BARB SOCKET, LONG BODY						
Non-Valved	Valved	Tube Size	Metric Tube	Length	Width	Height
50AC-S2-04LB	50ACV-SB2-04	1/4" ID	6.4mm ID	2.02"	.75"	.94"
50AC-S2-05LB	50ACV-SB2-05	5/16" ID	7.9mm ID	2.02"	.75"	.94"
50AC-S2-06LB	50ACV-SB2-06	3/8" ID	9.5mm ID	2.02"	.75"	.94"



IN-LINE PTF SOCKET, LONG BODY						
Non-Valved	Valved	Tube Size	Metric Tube	Length	Width	Height
50AC-S9-04LB	50ACV-SB9-04	1/4" OD, .17" ID	6.4mm OD, 4.3mm ID	1.95"	.75"	.93"
50AC-S9-06LB	50ACV-SB9-06	3/8" OD, .25" ID	9.5mm OD, 6.4mm ID	2.05"	.75"	.93"



PANEL MOUNT HOSE BARB SOCKET						
Non-Valved	Valved	Tube Size	Metric Tube	Length	Width	Height
50AC-S3-04	50ACV-SB3-04	1/4" ID	6.4mm ID	2.10"	.90"	1.05"
50AC-S3-05	50ACV-SB3-05	5/16" ID	7.9mm ID	2.10"	.90"	1.05"
50AC-S3-06	50ACV-SB3-06	3/8" ID	9.5mm ID	2.10"	.90"	1.05"



PANEL MOUNT PTF SOCKET						
Non-Valved	Valved	Tube Size	Metric Tube	Length	Width	Height
50AC-S8-04	50ACV-SB8-04	1/4" OD, .17" ID	6.4mm OD, 4.3mm ID	1.97"	.90"	1.05"
50AC-S8-06	50ACV-SB8-06	3/8" OD, .25" ID	9.5mm OD, 6.4mm ID	2.10"	.90"	1.05"



IN-LINE PUSH-IN SOCKET						
Non-Valved	Valved	Tube Size	Metric Tube	Length	Width	Height
50AC-S17-04	50ACV-SB17-04	1/4" OD	6.4mm OD	2.06"	.76"	.94"



PANEL MOUNT PUSH-IN SOCKET						
Non-Valved	Valved	Tube Size	Metric Tube	Length	Width	Height
50AC-S18-04	50ACV-SB18-04	1/4" OD	6.4mm OD	2.09"	.87"	1.05"

*See Accessories for Push-In fittings on page 44.



50AC Series Plugs

Tubing Size 1/4" - 3/8"
1/4" Flow Acetal (POM)



MALE THREAD PLUG

Non-Valved	Valved	Thread Size	L(nv/v)	Width	Height
50AC-PB1-04	50ACV-PB1-04	1/4" NPT	1.40"/1.75"	.55"	.55"
50AC-PB1-06	50ACV-PB1-06	3/8" NPT	1.40"/1.60"	.75"	.75"



IN-LINE HOSE BARB PLUG

Non-Valved	Valved	Tube Size	Metric Tube	L(nv/v)	Width	Height
50AC-PB2-04	50ACV-PB2-04	1/4" ID	6.4mm ID	1.35"/2.05"	.70"	.70"
50AC-PB2-05	50ACV-PB2-05	5/16" ID	7.9mm ID	1.93"/2.03"	.70"	.70"
50AC-PB2-06	50ACV-PB2-06	3/8" ID	9.5mm ID	1.35"/1.90"	.70"	.70"



IN-LINE PTF PLUG

Non-Valved	Valved	Tube Size	Metric Tube	L(nv/v)	Width	Height
50AC-PB9-04	50ACV-PB9-04	1/4" OD, .17" ID	6.4mm OD, 4.3mm ID	1.80"/1.96"	.63"	.63"
50AC-PB9-06	50ACV-PB9-06	3/8" OD, .25" ID	9.5mm OD, 6.4mm ID	1.74"/1.89"	.63"	.63"



ELBOW HOSE BARB PLUG

Non-Valved	Valved	Tube Size	Metric Tube	L(nv/v)	Width	Height
50AC-PB4-04	50ACV-PB4-04	1/4" ID	6.4mm ID	1.20"/1.45"	.63"	1.28"
50AC-PB4-06	50ACV-PB4-06	3/8" ID	9.5mm ID	1.20"/1.48"	.63"	1.28"



ELBOW PTF PLUG

Non-Valved	Valved	Tube Size	Metric Tube	L(nv/v)	Width	Height
50ACX-PB10-04	50ACV-PB10-04	1/4" OD, .17" ID	6.4mm OD, 4.3mm ID	1.33"/1.48"	.63"	1.15"
50AC-PB10-06	50ACV-PB10-06	3/8" OD, .25" ID	9.5mm OD, 6.4mm ID	1.34"/1.50"	.63"	1.30"



ELBOW MALE THREAD PLUG

Non-Valved	Valved	Thread Size	L (nv/v)	Width	Height
50AC-PB16-04	50ACV-PB16-04	1/4" NPT	1.29"/1.45"	.70"	1.47"



IN LINE PUSH-IN PLUG

Non-Valved	Valved	Tube Size	Metric Tube	L (nv/v)	Width	Height
50AC-PB17-04	50ACV-PB17-04	1/4" OD	6.4mm OD	1.91"/2.08"	.70"	.70"

**See Accessories for Push-In fittings on page 44.*

