

20PP Series Couplings

Tubing Size 1/16" - 1/4"
1/8" Flow Polypropylene

2 STANDARD
COLORS



20PP Series couplings offer 1/8" flow, are produced from medical grade, gamma sterilizable polypropylene, and offer greater chemical resistance. 20PP couplings interconnect with all other 20AC and 20CB Series couplings as well as other similar industry thumb-latch couplings. These couplings are available in Legacy Almond and Modern Cool Grey colors.

Performance Ratings:

- Operating Pressure: Vacuum to 120psi; (8.3bar)
- Temperature: 32°F to 160°F; (0°C to 71°C)
- Flow Capacity: 1/8" Size
- Sterilization: Gamma; 50 kGy irradiation max (see technical section for more detail)

Materials & Construction:

- Bodies & Terminations: Medical Grade Polypropylene
- Internal Valves: Medical Grade Polypropylene
- Internal Valve Springs: 316 Stainless Steel
- O-rings: Peroxide-cured EPDM (others available)
- Thumb-latch: Stainless Steel
- External Springs & Pins: Stainless Steel

20PP Series Air Flow

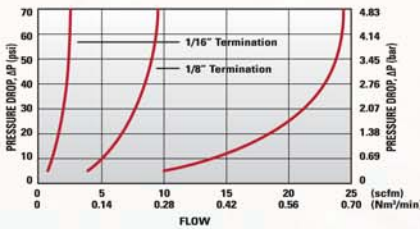

20PP Series Water Flow

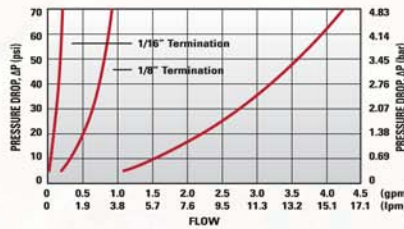

20PP Series Temperature

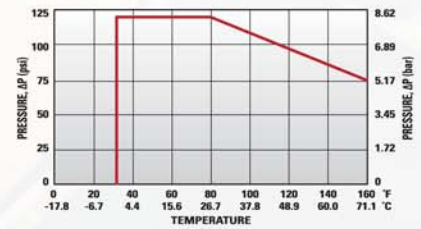

FLOW RATES

The data below shows liquid flow rates for LinkTech couplings. Each coupling combination was tested at 70°F (21°C).

C_v Values for 20PP Series Couplings

SOCKETS	20PPV-PE2-01	20PP-PE2-01	20PPV-PE2-02	20PP-PE2-02	20PPV-PE2-04	20PP-PE2-04	20PPV-PE9-04	20PPX-PE9-04	20PPV-PE1-02	20PPX-PE1-02	20PPV-PE4-04	20PPX-PE4-04
20PPV-SE2-01	0.02	0.02	0.03	0.03	0.03	0.03	0.03	0.03	0.03	0.03	0.03	0.03
20PP-S2-01	0.02	0.03	0.03	0.03	0.03	0.03	0.03	0.03	0.03	0.03	0.03	0.03
20PPV-SE2-04	0.03	0.03	0.16	0.22	0.21	0.26	0.17	0.23	0.19	0.25	0.24	0.27
20PP-S2-04	0.03	0.03	0.18	0.24	0.23	0.45	0.24	0.33	0.2	0.45	0.27	0.45
20PPV-SE3-02	0.03	0.03	0.14	0.17	0.15	0.19	0.15	0.19	0.18	0.18	0.15	0.19
20PP-S3-02	0.03	0.03	0.14	0.19	0.15	0.27	0.15	0.24	0.15	0.27	0.16	0.27
20PPV-SE3-04	0.03	0.03	0.16	0.22	0.21	0.26	0.17	0.23	0.19	0.26	0.16	0.25
20PP-S3-04	0.03	0.03	0.18	0.25	0.23	0.45	0.23	0.34	0.2	0.45	0.26	0.45
20PPV-SE8-04	0.03	0.03	0.16	0.2	0.17	0.22	0.17	0.21	0.17	0.21	0.18	0.22
20PP-S8-04	0.03	0.03	0.16	0.25	0.18	0.4	0.18	0.4	0.16	0.4	0.21	0.4
20PPV-SE1-02	0.03	0.03	0.16	0.24	0.2	0.28	0.18	0.27	0.2	0.26	0.24	0.26
20PP-S1-02	0.03	0.03	0.16	0.25	0.19	0.5	0.18	0.4	0.2	0.5	0.24	0.5
20PPV-SE1-04	0.03	0.03	0.17	0.25	0.23	0.3	0.19	0.3	0.21	0.27	0.24	0.29
20PP-S1-04	0.03	0.03	0.18	0.26	0.24	0.5	0.21	0.4	0.2	0.5	0.26	0.5

Specific coupling combination flow rates can be determined by using this formula:

$$Q = C_v \sqrt{\frac{\Delta P}{S}}$$

Q = Flow rate in gallons per minute
 C_v = Average flow rates (see chart)
 ΔP = Pressure drop across coupling (psi)
 S = Specific gravity of liquid.

	PANEL OPENING	MAX PANEL THICKNESS	MIN PANEL THICKNESS
SOCKETS	Per Drawing	0.5"	0.05"
PLUGS	0.5"	0.3"	0.05"

PANEL NUT HEX SIZE	PANEL NUT THREAD
5/8"	1/2" - 24 UNS

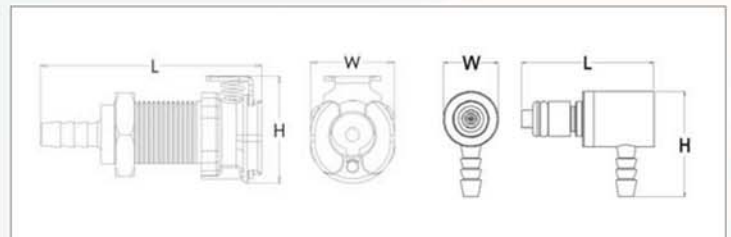
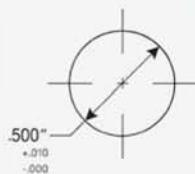

Reference Dimensions: L = Length, W = Width, H = Height

Tubing Size 1/16" - 1/4"
1/8" Flow Polypropylene

20PP Series Sockets

		MALE THREAD SOCKET					
Non-Valved	Valved	Thread Size	Length	Width	Height		
20PP-S1-02	20PPV-SE1-02	1/8" NPT	1.10"	.64"	.82"		
20PP-S1-02MALD	20PPV-SE1-02MALD	1/8" NPT	1.10"	.64"	.82"		
20PP-S1-04	20PPV-SE1-04	1/4" NPT	1.10"	.64"	.82"		
20PP-S1-04MALD	20PPV-SE1-04MALD	1/4" NPT	1.10"	.64"	.82"		

		IN-LINE HOSE BARB SOCKET					
Non-Valved	Valved	Tube Size	Metric Tube	Length	Width	Height	
20PP-S2-01	20PPV-SE2-01	1/16" ID	1.6mm ID	1.39"	.63"	.88"	
20PP-S2-01MALD	20PPV-SE2-01MALD	1/16" ID	1.6mm ID	1.39"	.63"	.88"	
20PP-S2-02	20PPV-SE2-02	1/8" ID	3.2mm ID	1.63"	.63"	.88"	
20PP-S2-02MALD	20PPV-SE2-02MALD	1/8" ID	3.2mm ID	1.63"	.63"	.88"	
20PP-S2-04	20PPV-SE2-04	1/4" ID	6.4mm ID	1.78"	.63"	.88"	
20PP-S2-04MALD	20PPV-SE2-04MALD	1/4" ID	6.4mm ID	1.78"	.63"	.88"	

		IN-LINE PTF SOCKET					
Non-Valved	Valved	Tube Size	Metric Tube	Length	Width	Height	
20PP-S9-025	20PPV-SE9-025	5/32" OD, .10" ID	4.0mm OD, 2.5mm ID	1.71"	.63"	.88"	
20PP-S9-025MALD	20PPV-SE9-025MALD	5/32" OD, .10" ID	4.0mm OD, 2.5mm ID	1.71"	.63"	.88"	
20PP-S9-04	20PPV-SE9-04	1/4" OD, .17" ID	6.4mm OD, 4.3mm ID	1.71"	.63"	.88"	
20PP-S9-04MALD	20PPV-SE9-04MALD	1/4" OD, .17" ID	6.4mm OD, 4.3mm ID	1.71"	.63"	.88"	

		PANEL MOUNT HOSE BARB SOCKET					
Non-Valved	Valved	Tube Size	Metric Tube	Length	Width	Height	
20PP-S3-01	20PPV-SE3-01	1/16" ID	1.6mm ID	1.40"	.63"	.88"	
20PP-S3-01MALD	20PPV-SE3-01MALD	1/16" ID	1.6mm ID	1.40"	.63"	.88"	
20PP-S3-02	20PPV-SE3-02	1/8" ID	3.2mm ID	1.65"	.63"	.88"	
20PP-S3-02MALD	20PPV-SE3-02MALD	1/8" ID	3.2mm ID	1.65"	.63"	.88"	
20PP-S3-04	20PPV-SE3-04	1/4" ID	6.4mm ID	1.80"	.63"	.88"	
20PP-S3-04MALD	20PPV-SE3-04MALD	1/4" ID	6.4mm ID	1.80"	.63"	.88"	

		PANEL MOUNT PTF SOCKET					
Non-Valved	Valved	Tube Size	Metric Tube	Length	Width	Height	
20PP-S8-025	20PPV-SE8-025	5/32" OD, .10" ID	4.0mm OD, 2.5mm ID	1.72"	.63"	.88"	
20PP-S8-025MALD	20PPV-SE8-025MALD	5/32" OD, .10" ID	4.0mm OD, 2.5mm ID	1.72"	.63"	.88"	
20PP-S8-04	20PPV-SE8-04	1/4" OD, .17" ID	6.4mm OD, 4.3mm ID	1.72"	.63"	.88"	
20PP-S8-04MALD	20PPV-SE8-04MALD	1/4" OD, .17" ID	6.4mm OD, 4.3mm ID	1.72"	.63"	.88"	

*MALD denotes Almond coupling color.

20PP Series Plugs

Tubing Size 1/16" - 1/4"
1/8" Flow Polypropylene



MALE THREAD PLUG

Non-Valved	Valved	Thread Size	L (nv/v)	Width	Height
20PPX-PE1-02	20PPV-PE1-02	1/8" NPT	1.27"/1.39"	.50"	.50"
20PPX-PE1-02MALD	20PPV-PE1-02MALD	1/8" NPT	1.27"/1.39"	.50"	.50"



IN-LINE HOSE BARB PLUG

Non-Valved	Valved	Tube Size	Metric Tube	L (nv/v)	Width	Height
20PP-PE2-01	20PPV-PE2-01	1/16" ID	1.6mm ID	.80"/1.48"	.55"	.55"
20PP-PE2-01MALD	20PPV-PE2-01MALD	1/16" ID	1.6mm ID	.80"/1.48"	.55"	.55"
20PP-PE2-02	20PPV-PE2-02	1/8" ID	3.2mm ID	.97"/1.65"	.55"	.55"
20PP-PE2-02MALD	20PPV-PE2-02MALD	1/8" ID	3.2mm ID	.97"/1.65"	.55"	.55"
20PP-PE2-04	20PPV-PE2-04	1/4" ID	6.4mm ID	1.12"/1.80"	.55"	.55"
20PP-PE2-04MALD	20PPV-PE2-04MALD	1/4" ID	6.4mm ID	1.12"/1.80"	.55"	.55"



IN-LINE PTF PLUG

Non-Valved	Valved	Tube Size	Metric Tube	L (nv/v)	Width	Height
20PPX-PE9-04	20PPV-PE9-04	1/4" OD, .17 ID	6.4mm OD, 4.3mm ID	1.15"/1.57"	.55"	.55"
20PPX-PE9-04MALD	20PPV-PE9-04MALD	1/4" OD, .17 ID	6.4mm OD, 4.3mm ID	1.15"/1.57"	.55"	.55"



ELBOW HOSE BARB PLUG

Non-Valved	Valved	Tube Size	Metric Tube	L (nv/v)	Width	Height
20PPX-PE4-02	20PPV-PE4-02	1/8" ID	3.2mm ID	1.10"/1.21"	.50"	.95"
20PPX-PE4-02MALD	20PPV-PE4-02MALD	1/8" ID	3.2mm ID	1.10"/1.21"	.50"	.95"
20PPX-PE4-04	20PPV-PE4-04	1/4" ID	6.4mm ID	1.10"/1.21"	.50"	1.10"
20PPX-PE4-04MALD	20PPV-PE4-04MALD	1/4" ID	6.4mm ID	1.10"/1.21"	.50"	1.10"



ELBOW PTF PLUG

Non-Valved	Valved	Tube Size	Metric Tube	L (nv/v)	Width	Height
20PPX-PE10-04	20PPV-PE10-04	1/4" OD, .17 ID	6.4mm OD, 4.3mm ID	1.10"/1.21"	.62"	.80"
20PPX-PE10-04MALD	20PPV-PE10-04MALD	1/4" OD, .17 ID	6.4mm OD, 4.3mm ID	1.10"/1.21"	.62"	.80"

*MALD denotes Almond coupling color.



Available in Modern Cool Grey
and Legacy Almond Color.