

**Clean Series Air Cylinder
/ Direct Mount Cylinder**

Series CR(CV)AXR

Bore Size : ϕ 20, ϕ 25, ϕ 32, ϕ 40

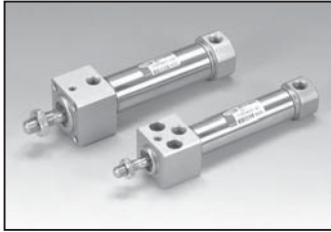

- Cylinder in low particle generation for clean room.
- Piston rod is made in the material quality of stainless steel to enhance resistance against moisture and other chemicals.
- Exclusive grease use, dust generation is minimized when cylinder is acting.
- Adjustable stroke available.

How to Order

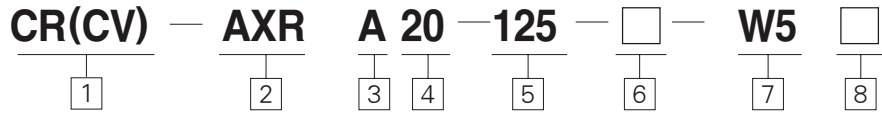

- 1 Clean series**
CR : Relief Port Type
CV : Vacuum Suction Type
- 2 Air Cylinder(double acting, single rod)**
basic type : built-in magnet
- 3 Attaching Type**
A : bottom side mounting
B : front side mounting
- 4 Bore Size**
20 : 20mm 25 : 25mm
32 : 32mm 40 : 40mm
- 5 Cylinder Stroke(mm)**
Please refer to the table of cylinder stroke.
- 6 Cushion**
Blank : rubber cushion type
XC16 : Palpitation is impossible.
- 7 Sorts of Auto Switch**
Blank : no auto switch
(cylinder with built-in magnet)
auto switch with contacting point
- band attaching type(grommet)
- W5
※ The standard length of lead wire is 0.5m
※ For length lead wire over 3m, L is added to the end of part number.
- 8 Symbols of Auto Switch**
Blank : 2 pieces attached
S : 1 pieces attached
n : n pieces attached

Specifications

Bore size	ϕ 20, ϕ 25, ϕ 32, ϕ 40	
Models	Relief Port Type, Vacuum Suction Type	
Operation Type	Double Acting, Single Rod(Non-Lubrication)	
Port Size	ϕ 20, 25, 32	Rc(PT) 1/8
	ϕ 40	Rc(PT) 1/4
Fluid	Air	
Proof Pressure	1.5MPa(217.6psi)	
Max. Operation Pressure	1.0MPa(140.8psi)	
Min. Operation Pressure	0.05MPa(7.1psi)	
Ambient and Fluid Temperature · °C(°F)	-10°C~70°C (14~158°F) (Anti Freezing)	
Cushion	Rubber Cushion	
Stroke Tolerance	$^{+1.4}_0$ mm	
Piston Speed	50~400mm/s	
Attaching Type	Bottom side mounting, Front side mounting	

Table of standard stroke/air pressure(no lubrication type)
(Unit: mm)

Bore Size	Cylinder stroke
20,25,32,40	25,50,75,100,125,150,175,200,250,300

Band to attach auto switch/parts number

Type of Auto Switch	Bore Size(mm)			
	20	25	32	40
W5	TBM2-020	TBM2-025	TBM2-032	TBM2-040

- ACP/ UACP
- APM
- AS
- AX
- AM
- AM2
- AL/ ALX
- AQ/ UAQ
- ADQCP
- AQ2/ UADQ2
- AG/ UAG
- NGQ/ UNGQ
- AJ/ AJM
- ABK
- NSK
- GX/ AGX
- NDM
- ADR
- AMR/ UAMR
- NST
- AST
- ASTH
- NF
- NLCD
- NLCS
- TCRL
- NP
- ARD/ UARD
- NR
- ASL
- SB
- SAH
- CR/ CV
- CR/ CV-AQ2,ADQ2
- CR/ CV-AX**
- CR/ CV-NLCD
- CR/ CV-AGL
- DR100
- RS
- DV1000/ 3000/4000
- DS300
- DS2000