

REPLACEMENT INSTRUCTIONS

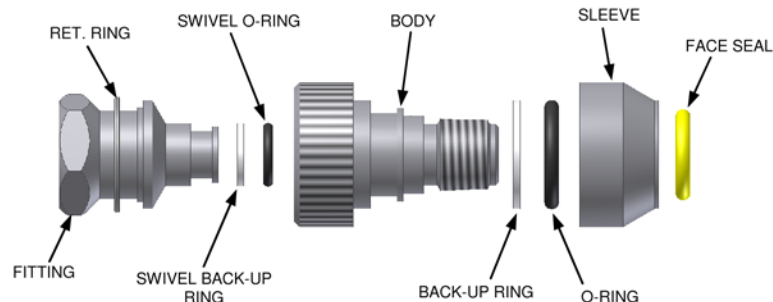

EXPLODED VIEW OF SWIVEL CONNECTOR



CONNECTOR MAINTENANCE:

- A daily, weekly and periodic inspection of the connector by competent person is recommended.
- User must establish a regular interval for maintenance as determined by the user media and operational environment.
- Inspection should include damage to the body missing or loose components, leak tightness, ease of operation, sufficient lubrication, wear, dirt accumulation and damage.
- Inspect threads for wear.
- Use only original **FasTest** spare parts that are designed for the application and are subject to strict quality control. See Warranty.
- Lubricate on regular intervals under normal operating conditions. Lubrication should be compatible with user application.

FasTest, Inc. Product Warranty

FasTest, Inc. warrants its products against defects of workmanship and/or material for 12 months from the date of the sale by FasTest, Inc. This warranty is void if the product is misused, tampered with or used in a manner that is not in accordance with FasTest, Inc. recommendations and/or instructions. FasTest, Inc. is not liable for consequential or other damages including, but not limited to, loss, damage, personal injury, or any other expense directly or indirectly arising from the use of or inability to use its products either separately or in combination with other products. ALL OTHER WARRANTIES EXPRESSED OR IMPLIED, WHETHER ORAL OR WRITTEN, INCLUDING BUT NOT LIMITED TO WARRANTIES OR MERCHANTABILITY OR FITNESS FOR A PARTICULAR PURPOSE ARE EXPRESSLY EXCLUDED.

Remedy under this warranty is limited to replacement of the product or an account credit in the amount of the original selling price, at the option on FasTest, Inc. All allegedly defective products must be returned prepaid transportation to FasTest, Inc. along with information describing the products performance, unless disposition in the field is authorized in writing by FasTest, Inc.

MITR *TwistMate* Internal Seal Replacement Instructions.

Description: Internal Seal and Back-Up Ring Replacement Instructions for NPT, JIC and SAE O-Ring Boss Connectors.

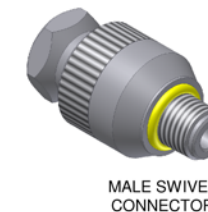
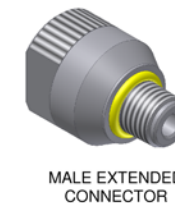

Please thoroughly read the following two steps on properly replacing seals and back-up rings on MIT Connectors.

1. Male Plug and Male Extended Connector Internal Seal Replacement.
2. Male Swivel Connector Internal Seal Replacement.

FACE SEALS SOLD SEPARATELY!

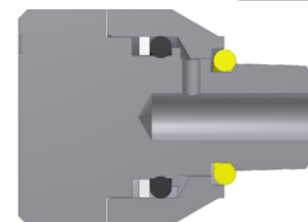

PLUG CROSS-SECTION

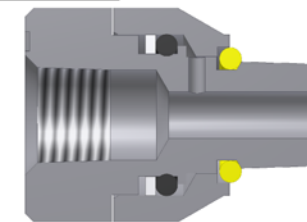

MALE EXTENDED CROSS-SECTION

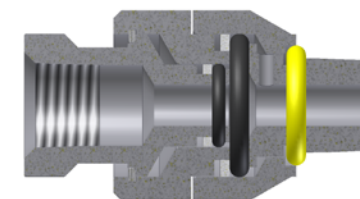

MALE SWIVEL CROSS-SECTION

WARNING: If instructions are not clear or components are missing, contact factory before using connector.

REPLACEMENT INSTRUCTIONS



Male Plug and Male Extended Connector Seal Replacement:

1. Remove face seal (A) from connector using a sharp tool and save. Face seals sold separately.

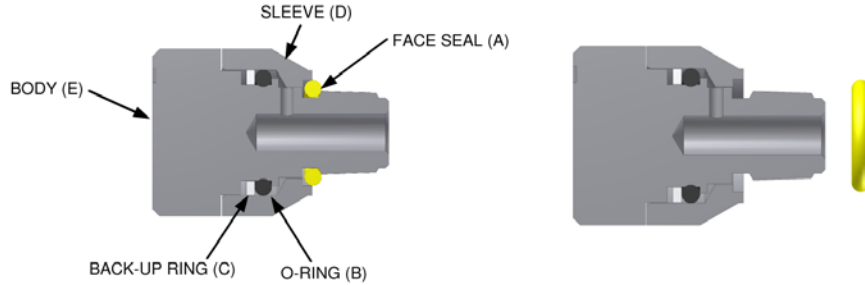

2. Remove sleeve (D) to expose o-ring (B) and back-up ring (C). Remove and discard old o-ring and back-up ring.

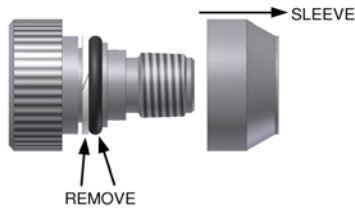

3. Make sure body (E) and sleeve (D) are clean and free of dust and dirt before reassembling new components to the connector.

4. Install new back-up ring (C) as shown.



5. Lubricate new o-ring (B) with petroleum jelly and install as shown.

6. Replace sleeve (D) and use a slight twisting motion to ensure that the seals remain in the ring groove.

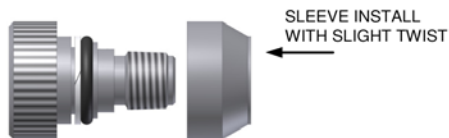

7. Install face seal (A).



Male Swivel Connector Seal Replacement:

1. Remove face seal (A) from connector using a sharp tool and save. Face seals sold separately.

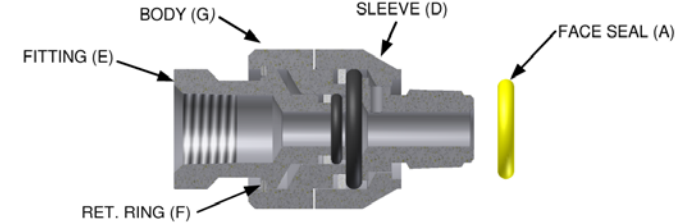

2. Remove sleeve (D) to expose o-ring (B) and back-up ring (C). Remove and discard old o-ring and back-up ring.

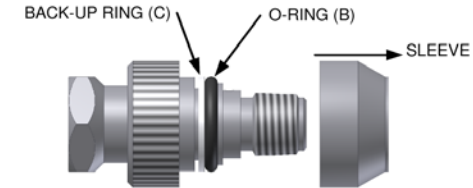

3. Make sure body and sleeve are clean and free of dust and dirt before reassembling new components to the connector.

4. Install new back-up ring (C) as shown.



5. Lubricate new o-ring (B) with petroleum jelly and install as shown.

6. Replace sleeve (D) and use a slight twisting motion to ensure that the seals remain in the ring groove.

7. Install face seal (A).



8. Remove ret. ring (F) and discard. (This can be difficult; a sharp, stiff, bent tip pick is required).

9. Remove fitting (E).

10. Remove and replace back-up ring (I).

11. Remove and replace o-ring (H), lube new o-ring.

12. Install fitting (E). Use a slight twisting motion to ensure that the seals remain in the ring groove.

13. Install the retaining ring, making sure it is completely seated in its groove.

FINISHED ASSEMBLY

