

GTEK AUTOMATION

A Division of Pacific Air Engineering, Inc.

MODEL GTA-10RNS to GTA-20RNS AIR/VACUUM PUMP

TECHNICAL DATA

P/N:	GTA-10RNS-*-DB1	GTA-12RNS-*-DB1	GTA-15RNS-*-DB1	GTA-20RNS-*-DB1
Voltage:	115VAC (50/60Hz) or 230VAC (50/60Hz)			
Motor Power:	40W			
Open Flow Air Output:	* 0.35 CFM (10 LPM)	* 0.42 CFM (12 LPM)	* 0.53 CFM (15 LPM)	* 0.71 CFM (20 LPM)
Max. Vacuum	-19.29 InHg (-490 mmHg)	-21.26 InHg (-540 mmHg)	-23.61 InHg (-600 mmHg)	-25.59 InHg (-650 mmHg)
Max. Pressure	28 PSI (2 Kg/cm ²)	35 PSI (2.5 Kg/cm ²)	64 PSI (4.5 Kg/cm ²)	85 PSI (6 Kg/cm ²)
Dimensions:	5.63" L x 4.64" H x 3.70" W (143mm L x 118mm H x 94mm W)			
Weight:	3.74 LBS (1.7 Kg)			
Motor Type	4 Pole, Capacitor Start, with Thermal Protector and Inner Cooling Fan.			
Connection Type:	1/8" Female NPT Inlet and Outlet Air Ports			

* To Order Please Use P/N-Voltage. IE: P/N GTA-10RNS-115VAC-DB1 or GTA-10RNS-230VAC-DB1.

* Approx. Flow Rates.

Output Air Flow

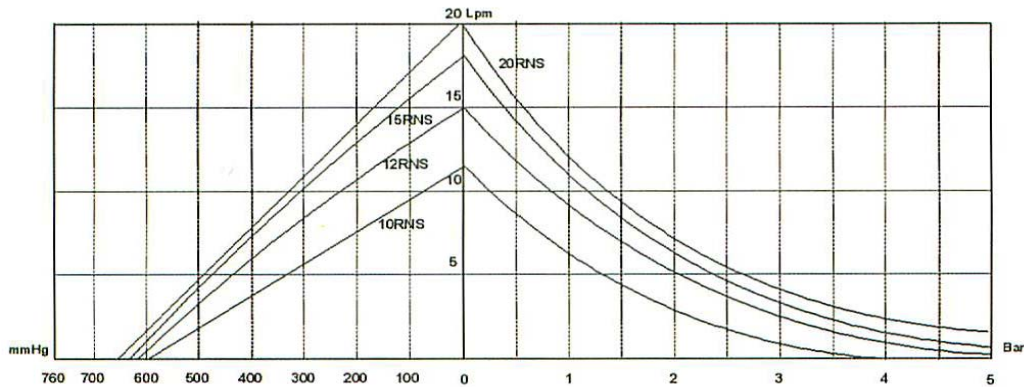

Mini Oil-less Piston Pump (Single head Type)

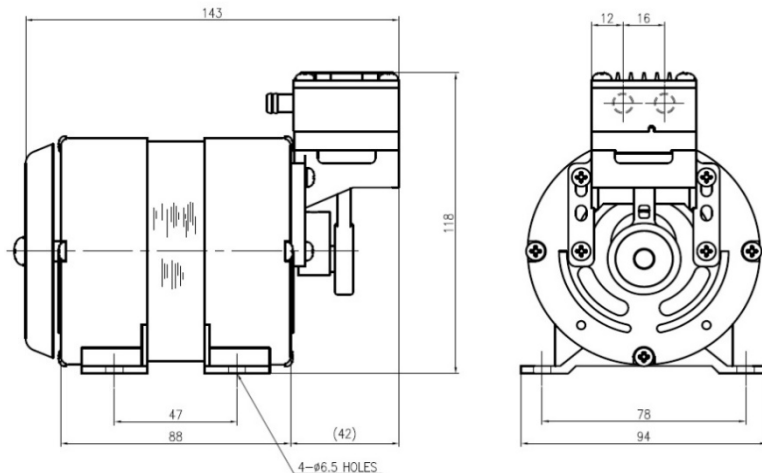

GTEK AUTOMATION

A Division of Pacific Air Engineering, Inc.

26212 Dimension Drive, Suite 150, Lake Forest, CA 92630

Ph. 949-680-4242, Fax. 949-680-4243, Email: Sales@Gtek-Automation.com

Web Site: Gtek-Automation.com