

**MAINTENANCE AND CARE**

A daily, weekly and periodic inspection of the connector by competent person is recommended. Lubricate connector on regular intervals. Petroleum jelly is recommended but care should be taken to verify the lubricant is compatible with the application. User must establish a regular interval for maintenance as determined by the user media and operational environment. Inspection should include; damage to the body, missing or loose components, leak tightness, ease of operation, sufficient lubrication, wear, dirt accumulation and damage. Use only original FasTest spare parts that are designed for the application and are subject to strict quality control. See CHART 2 on pg. 9 for seal sizes and part numbers.

- A. Replacing Main Seal
- B. Replacing Internal Seals

**A. Replacing Main Seal**

1. If replacing seals only, inspect washers for warping, corrosion, or excessive wear.
2. Replace complete FasTest main seal set if washers are warped, corroded, or worn.
3. See "Installation of Seals" section for detailed instructions.

**B. Replacing Internal Seals**

1. Loosen set screw (1) and remove seal casing (2) and main seal set (3).
2. Remove piston (4). This may require a short blast of air pressure.
3. Use a small pick to remove the internal o-rings. See Figure 10.
4. Lubricate the new o-rings with petroleum jelly and re-install.
5. Re-install piston, main seal set, seal casing, and set screw.

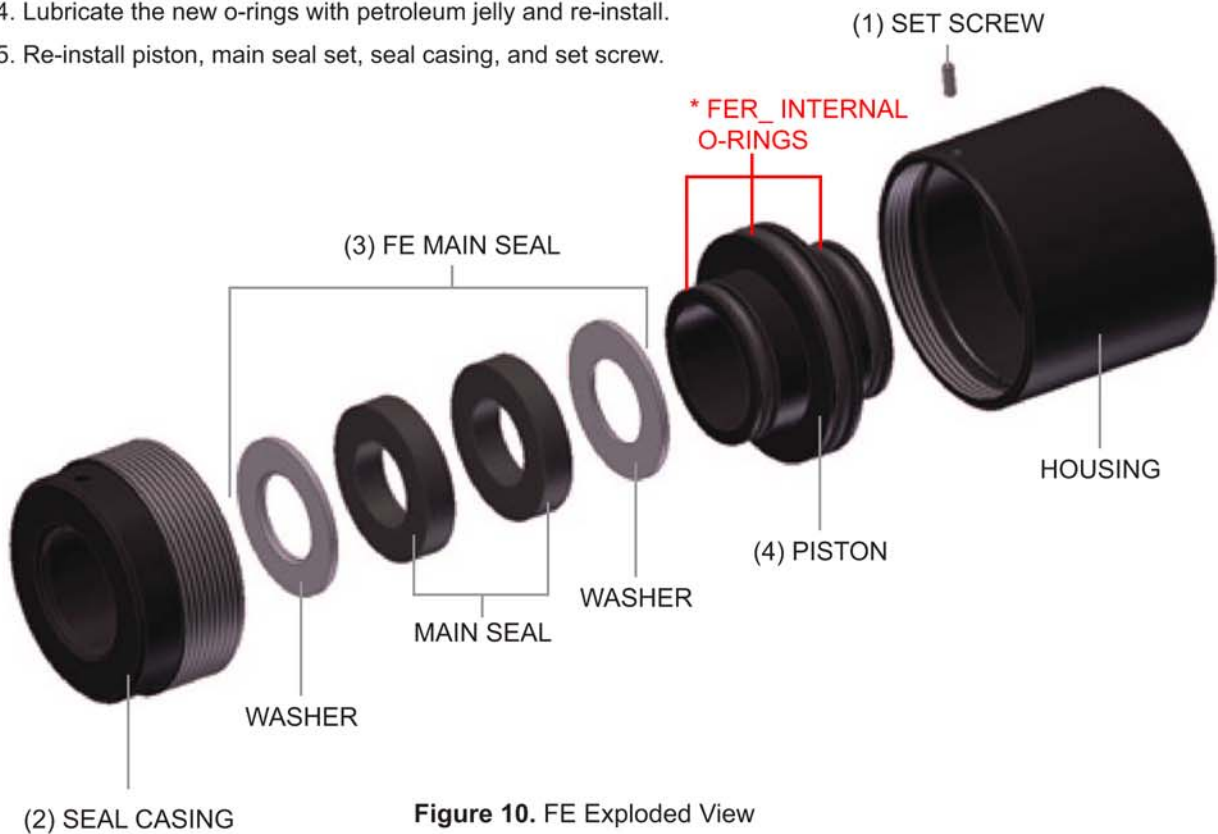

**Figure 10. FE Exploded View**

### C. Replacing Internal Seals on a Connector with Connection Verification

1. Follow steps (1) and (2) in section B.
2. Take care when removing the piston because the Actuator Assembly can come out. See Figure 11.
3. Follow steps (3) through (5) in section B.

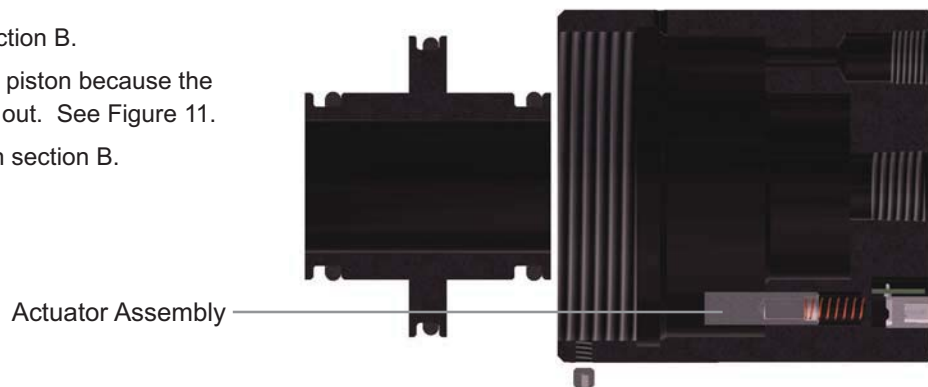

**Figure 11.** FE Section View