

**MAINTENANCE AND CARE**

A daily, weekly, and periodic inspection of the connector by a competent person is recommended. Lubricate connector at regular intervals. Petroleum jelly is recommended but care should be taken to verify the lubricant is compatible with the application. Users must establish a regular interval for maintenance as determined by the user media and operational environment. Inspection should include damage to the body, missing or loose components, leak tightness, ease of operation, sufficient lubrication, wear, dirt accumulation, and damage. Use only original FasTest spare parts that are designed for the application and are subject to strict quality control. See CHART 2 on pg. 9 for seal sizes and part numbers.

- 6. Replacing Main Seal
- 7. Replacing Internal Seals
- 8. Replacing Internal Seals on an FE with Sure Seal™

**6. Replacing Main Seal**

- 6.1. If replacing seals only, inspect washers for warping, corrosion, or excessive wear.
- 6.2. Replace complete FasTest main seal set if washers are warped, corroded or worn.
- 6.3. See the “Installation of Seals” section for detailed instructions.

**7. Replacing Internal Seals**

- 7.1. Loosen set screw (A) and remove seal casing (B) and main seal set (D).  
**Note: if repairing a connector with Sure Seal™, refer to step 8 on page 8**
- 7.2. Remove piston (G). This may require a short blast of air pressure. (A) SET SCREW
- 7.3. Use a small pick to remove the internal o-rings.  
 See Figure 8.
- 7.4. Lubricate the new o-rings with petroleum jelly and re-install.
- 7.5. Re-install piston, main seal set, seal casing, and set screw.

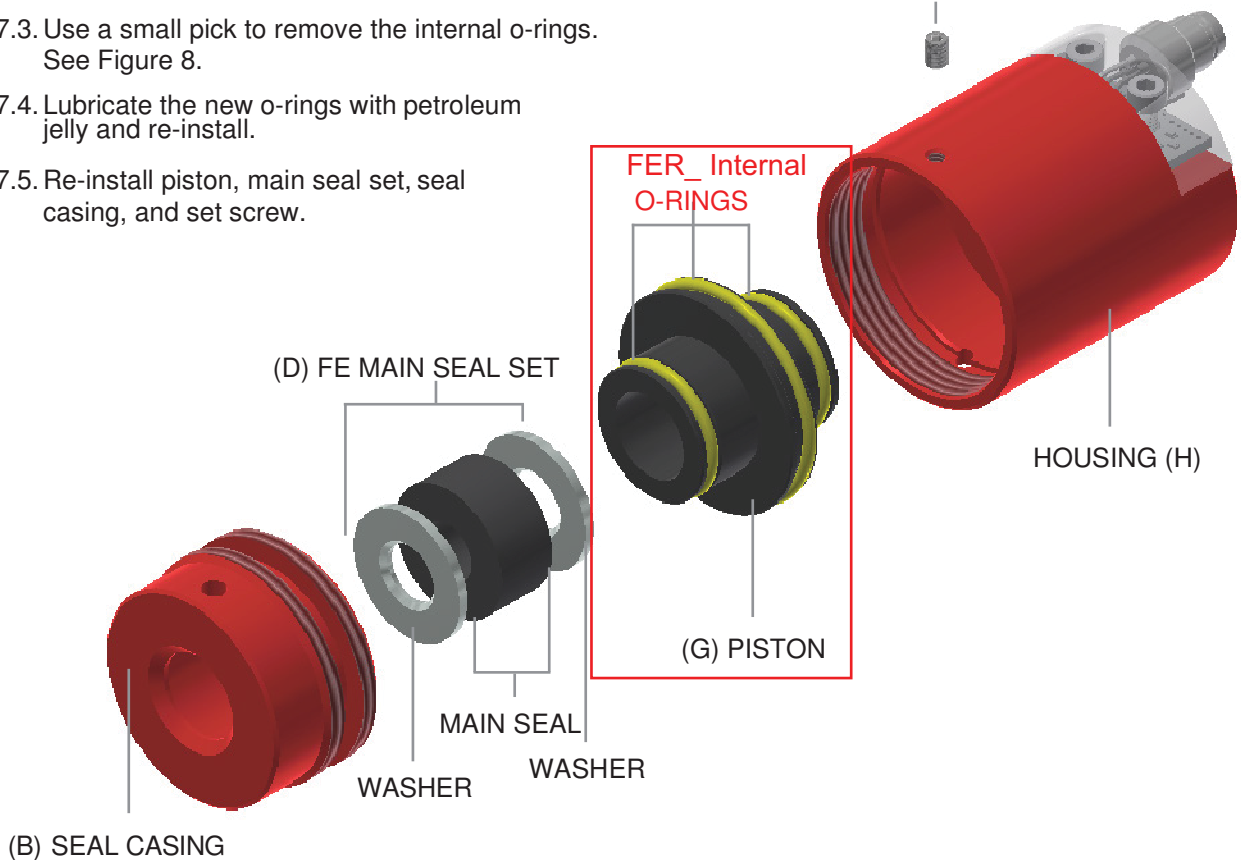

**Figure 8. FE Exploded View**